

Synthetic waterproofing, BauderPIR thermal insulation, lightweight industrial roof with a slope of at least 2%

Capping sheet (mechanically secured):
BauderTHERMOPLAN T 15/18/20

Insulation material (mechanically secured):
Mineral fibre insulation

Vapour barrier (cold self-adhesive):
BauderTEC DBR

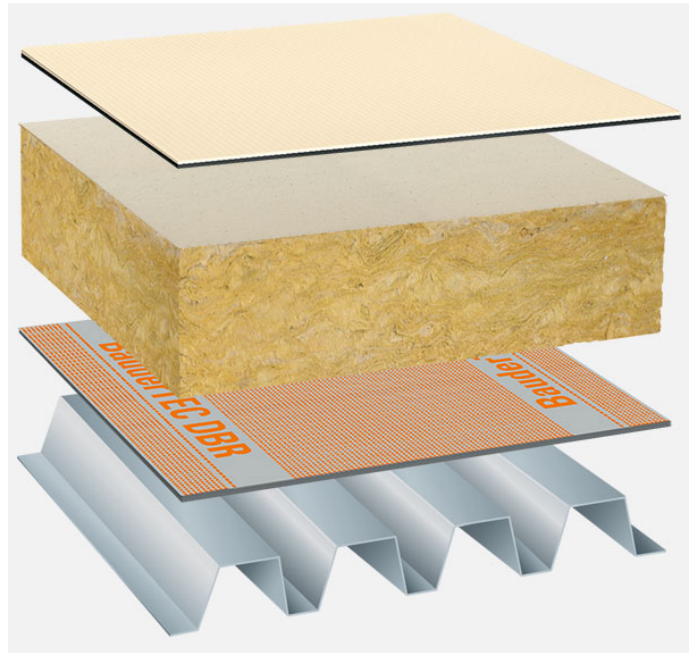

System build-up: IG_MIFA-P_T_01

The flat roof structure shown is a recommendation based on the selected parameters. Object-specific features and legal regulations must be clarified and adhered to in advance. This recommendation does not replace a consultation with a Bauder specialist consultant or Bauder Application Technology.

Notes: